

LIGHTING RAIL LOAD RATINGS  
GALLERY LEVEL (Level +21)  
REFER SHEET 2 FOR DETAILS

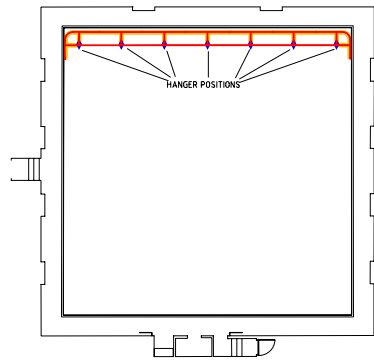

LADDER FRAME LOAD RATINGS  
HUNG FROM CEILING  
REFER SHEET 2 FOR DETAILS

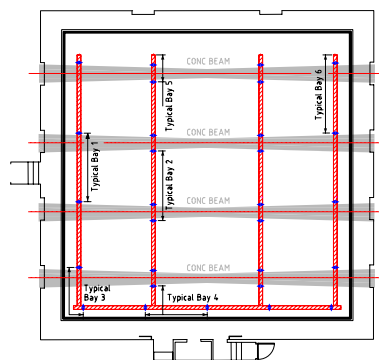

LOAD RAILS LOAD RATINGS  
HUNG FROM CONCRETE BEAMS  
REFER SHEET 2 FOR DETAILS

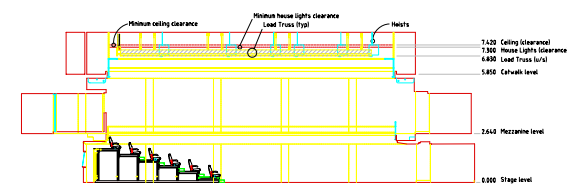

NORTH - SOUTH SECTION

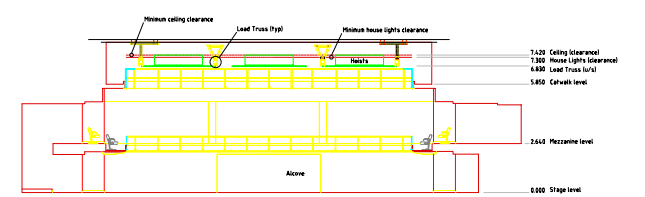

EAST - WEST SECTION

GALLERY LEVEL

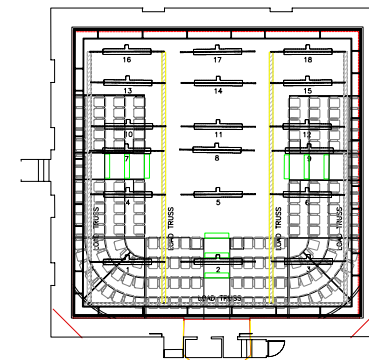
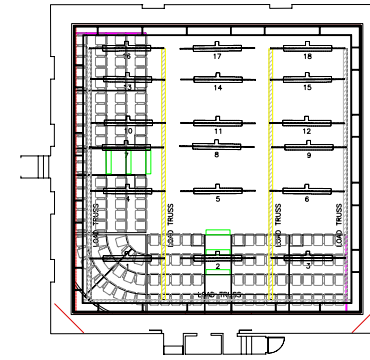
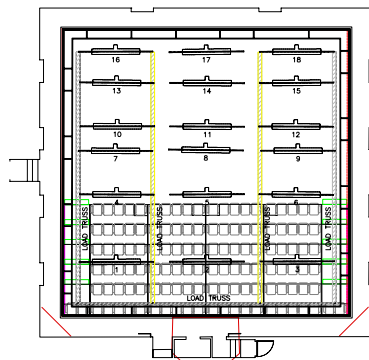
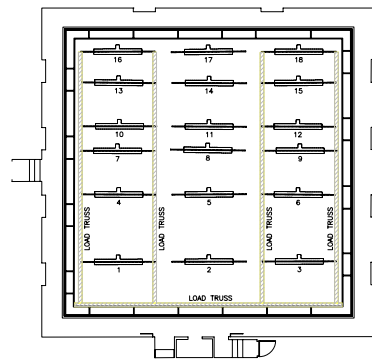

MEZZANINE LEVEL

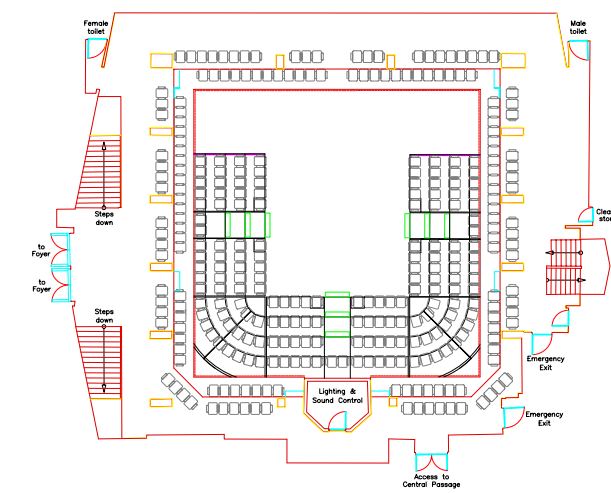
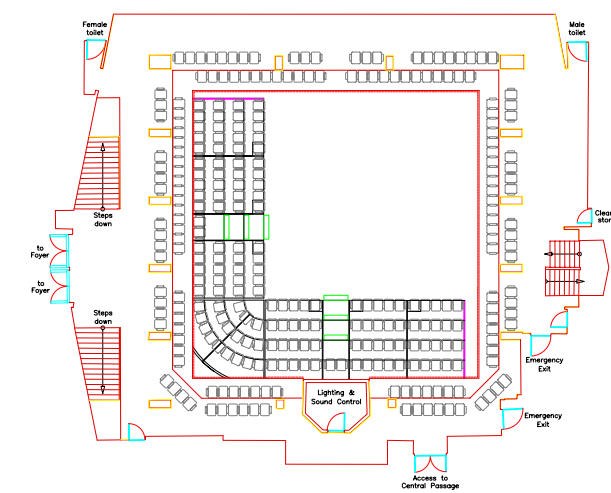
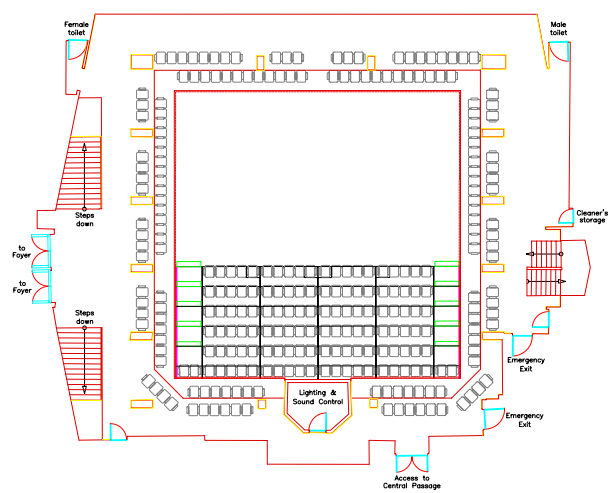
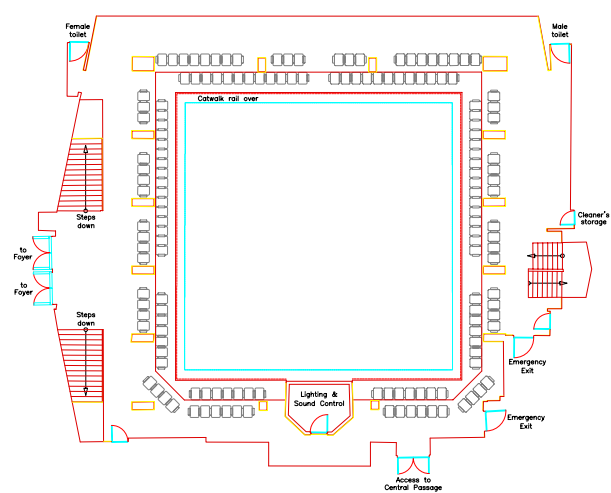

STAGE LEVEL

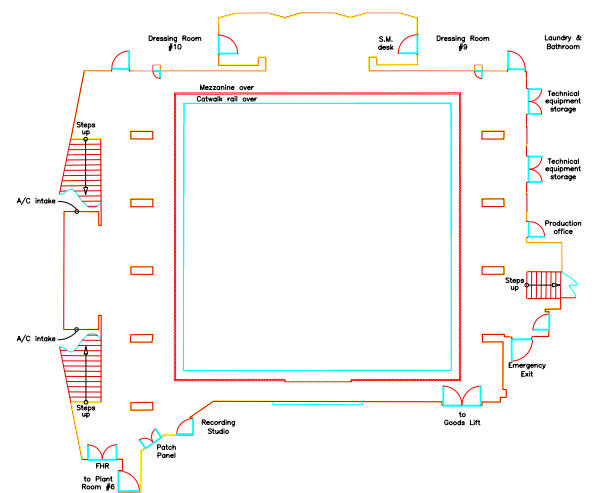

NO SEATING

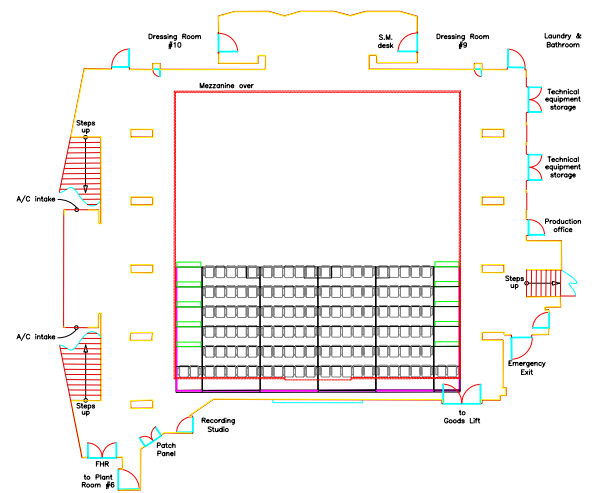

END SEATING

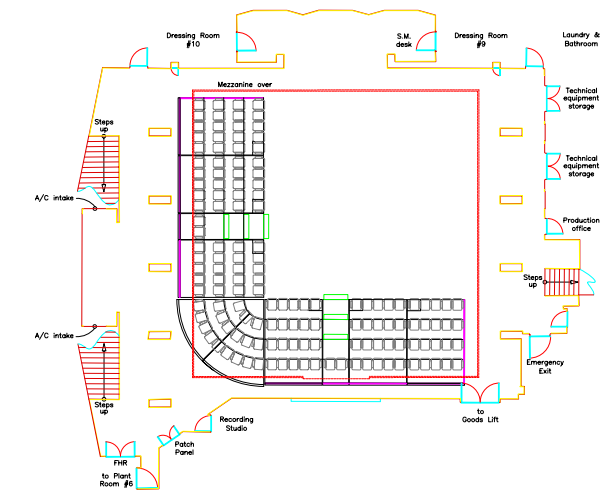

'L' SHAPED SEATING

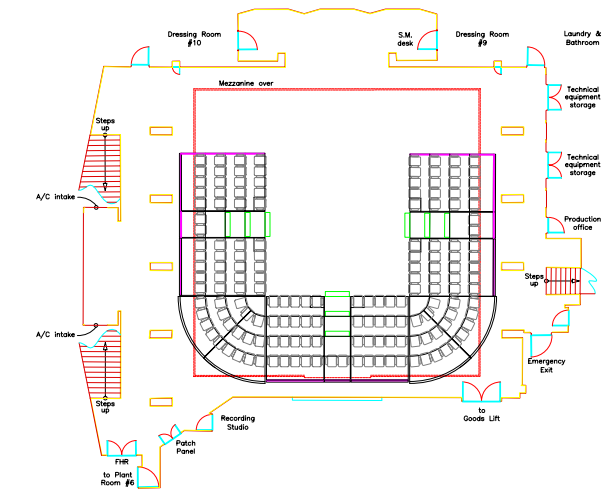

'U' SHAPED SEATING

0 5 10 15 20m

1 : 200

VENUE : THE STUDIO  
CONTENT : PLAN SECTION ELEVATIONS  
DATE : 05.2007

INTELLECTUAL PROPERTY: Sydney Opera House Trust may hold the intellectual property rights associated with the image and/or software. This information shall be considered copyright except for the sole purpose of assisting the person or organization named in this transfer in performing tasks associated with the nominated project. This image and/or software and associated or derived information shall not be used for other purposes or transferred to others without the permission of Sydney Opera House Trust, January 2007.